

The Denali

a luxurious recreational retreat

Fun Fact
Mount McKinley, located within Denali National Park and Preserve, is the highest mountain on the North American continent. The mountain's vertical relief of 18,000 feet is greater than that of Mount Everest.



The Denali (De-na-li), named after a mountainous Alaskan National Park fits this design perfectly with its edgy lines and rustic exterior. At first glance, you will notice the multiple roof lines that give the Denali a profile of a mountain range. The exterior finish blends perfectly with the outdoors by using a combination of real wood textures. The Denali also includes the porches, one of which is elevated to give that observation deck feel. All of the porches include glass railings to offer an un-obstructed view of the beautiful outdoors. As you take your first steps inside, you will notice the spacious, warm layout. The kitchen features a peninsula giving you enough seating for four, and paired with the open living room, there is enough room to entertain a crowd. As you walk past the ambient electric fireplace, you can open up the living room to one of the outdoor living spaces. The Denali features a loft design second to none with its vaulted design that leads you to the elevated observation deck with a spiral stair case. Going back down to the main floor, you notice the beautiful full size bath with shower spa giving you relaxation and tranquility after a long day. The master suite allows room for a queen size bed and has exclusive access to outdoor relaxation on one of Denali's decks. This home provides a fun, relaxing design that gives you all of the beauty of the outdoors while allowing you to enjoy the comfort of the woods!

Unique Features

- 400 sq.ft.
- multiple roof lines
- wrapping kitchen island
- comfortable, circulating heating and cooling
- 2 lower decks
- variety of exterior textures
- access to upper deck via spiral stairs or loft entry
- indoor/outdoor audio system
- 1 upper deck
- "spa" shower experience
- ample storage in the floor
- much more...

Typical "UV" Construction Features

- 2x4 exterior wall construction with ZIP system sheeting
- patented #6018921 insulated floor system
- Sea-Gull LED lighting
- solid surface countertops
- closed cell spray foam in walls, ceilings, and floor
- Pella windows and doors
- Whirlpool appliances
- and more...
- Kohler plumbing products
- Merillat cabinets
- drywall walls with wood accents

KOHLER

Merillat
We are America's Cabinetmaker.



Sea Gull Lighting
Life Illuminated | Since 1919



ZIPsystem
FOOT & WALL SHEETING



3834 E. Puetz Road | Oak Creek, Wisconsin 53154

T: 414.762.0950 | F: 414.762.0955

sales@utopian-villas.com | www.utopian-villas.com



Rev. 7-15

Denali Floor Plan

Main Floor

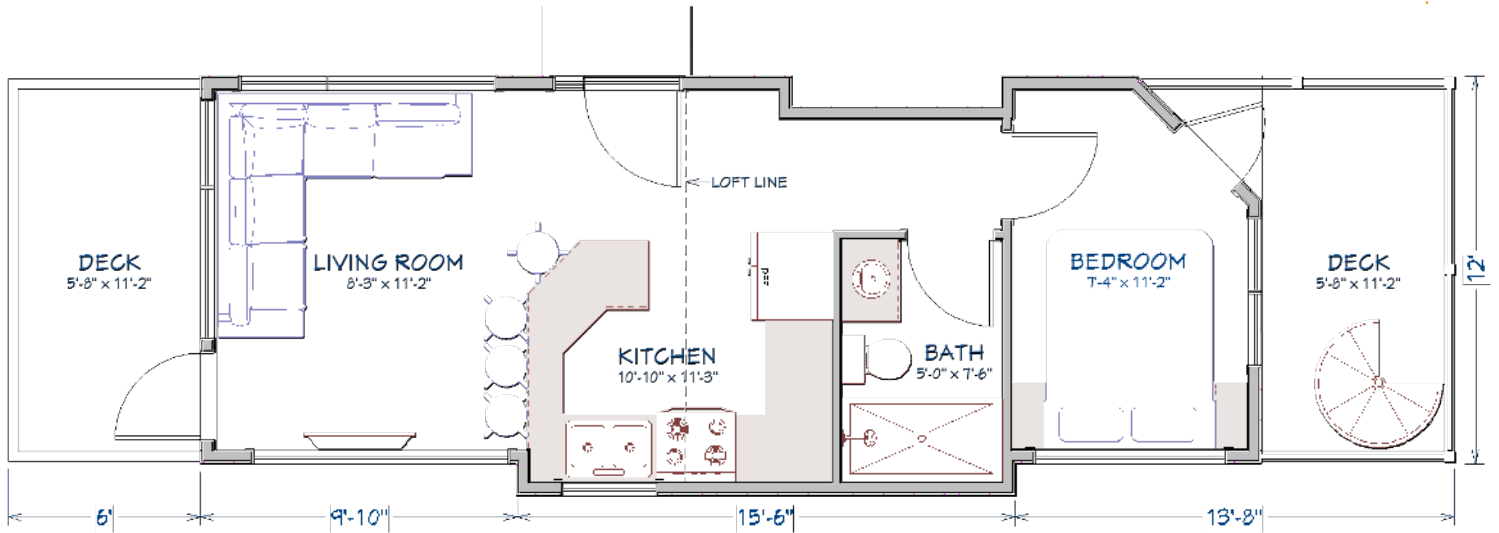

Loft

